

Topographical Plan & Beacon Certificate (WGS84)
 for erf 4172 Kenton-on-Sea
 Administrative District of Bathurst
 Province of the Eastern Cape
 Scale: 1/250 (@A3)
 (Heights at 0.50 metres amsl)

Beacon descriptions:
 A,B,C,D,E,F.....12mm iron pegs



LEGEND	
	Contour at 0,5m intervals
	Electrical box
	Man-hole Electrical ??
	Approx. position of tree & "drip line"

X + 372 8150

X + 372 8175

Y + 30 600

Y + 30 575

Y + 30 550

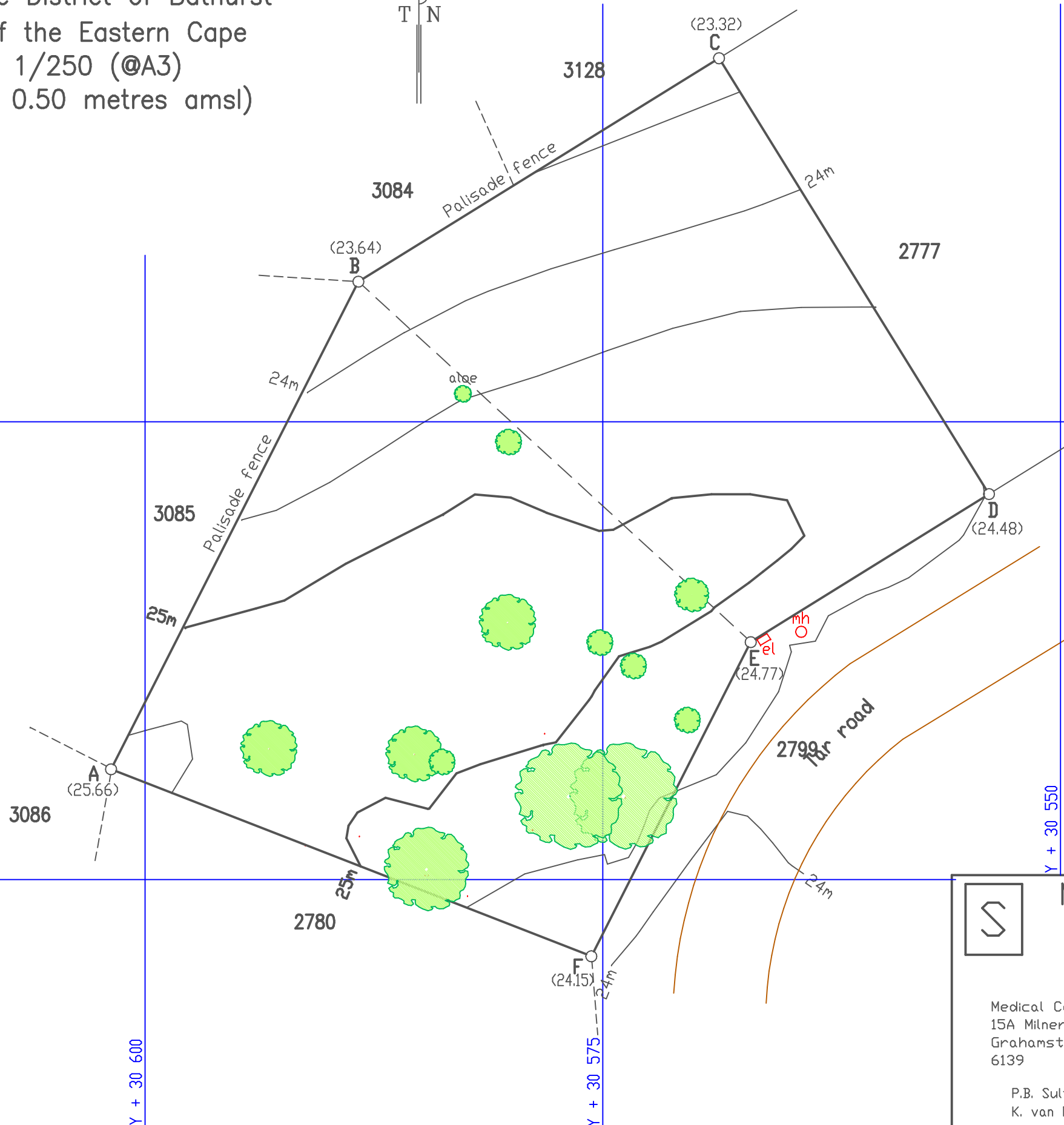

Surveyed by me in accordance with the provisions of the Land Survey Act No. 8 of 1997 and the regulations framed thereunder.
 Date: February 2024

P.B. SULTER
 Land Surveyor 0786

Date: February 2024



M.E.H SULTER & SON INC.

Professional Land Surveyors
 Township & Property Consultants
 Sectional Title Practitioners

3D scanning and building information modelling

Medical Centre
 15A Milner Street
 Grahamstown
 6139

Tel: 046 - 622 4441
 e-mail: peter@surveyec.co.za

P.B. Sulter
 K. van Niekerk

B.Sc.(SURVEY) Pr.L.(S.A.G.C.) Dip.Proj.Man.
 B.Sc.(GEOMATICS) Pr.L.(S.A.G.C.)