

First Floor Plan (Scale 1:100 @ A3)

GROUND FLOOR

83m² Built Area
42m² Double Garage
17m² Covered Terrace
4m² Entrance Doorstep

146m² Gross Built Area

13m² Open Drying Yard

FIRST FLOOR

55m² Built Area

201m² Total Built Area

SITE NUMBER & AREA - CYCAD CLOSE

02 - 353m² - Open Site Area Remaining - 207m²

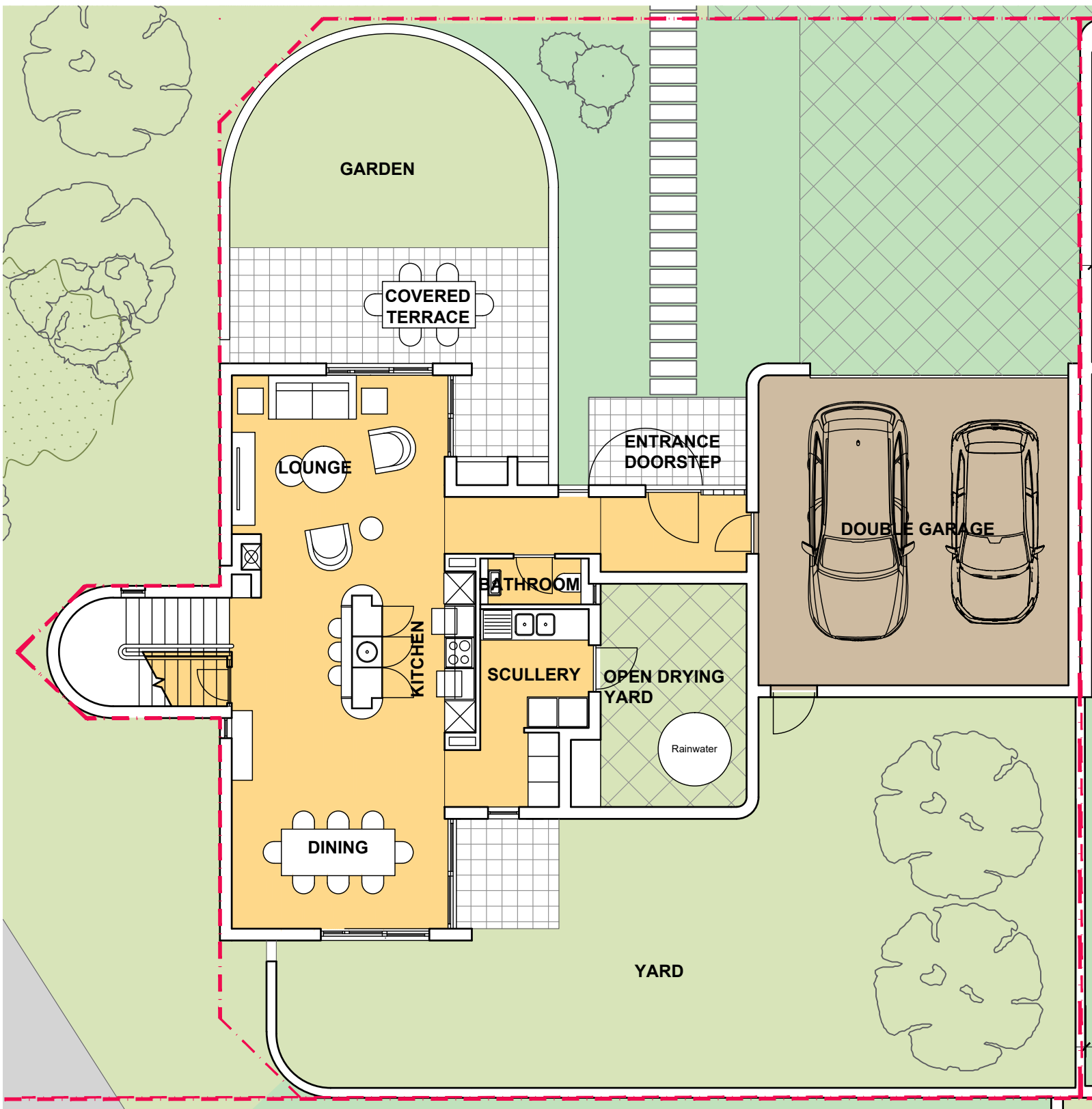
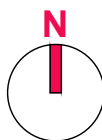

Ground Floor Plan (Scale 1:100 @ A3)

ANNEXURE C

Project Title:
ARBOUR ESTATE
GEORGE, WESTERN CAPE

All work to be done from figured dimensions only. All work must comply with the SABS SANS 10400, the SA National Building Regulations and relevant SA National Standards. All dimensions and levels to be confirmed on site prior to the commencement of work, before producing shop drawings or manufacturing of any component, and on site before ordering of any component. All dimensional discrepancy to be reported to Robert Silke & Partners. Information contained in this drawing remains the intellectual property of Robert Silke & Partners and is subject to copyright

Drawing Title:
Typical Type C3
Cycad Close
Ground & First Floor

Drawing Scale:
1:100

Robert Silke
& partners

Robert Silke & Robert McGiven in partnership
Robert Silke is a registered PrArch with SACAP - Reg. No. 20900
Robert McGiven is a registered PrArch with SACAP - Reg. No. 6934

SIGNATURA

arbour
NATURE ESTATE

G:\shortcut-targets-by-ld\1qxoBTK9PVA\739bg2Bv3dUOXE7HWx\202203 Arbour Estate\15.0 Marketing\new Annexure.dwg